

## Electrical Cable Trunking

Description	CID	Cut Type	Pat Gp
Trunking	877	Equipment	Electrical
Top Lid 45 Bend	878	Equipment	Electrical
Top Lid 90 - Gusset	878	Equipment	Electrical
Top Lid 90 - Square	878	Equipment	Electrical
Top Lid Tee - Gusset	879	Equipment	Electrical
Top Lid Tee - Square	879	Equipment	Electrical
Crossover	880	Equipment	Electrical
Inside Lid 45 Bend	900	Equipment	Electrical
Inside Lid 90 Square	900	Equipment	Electrical
Outside Lid 45 Bend	900	Equipment	Electrical
Outside Lid 90 Square	900	Equipment	Electrical
Bellmouth	901	Equipment	Electrical
Reducer	901	Equipment	Electrical
Inside Lid Tee - Gusset	905	Equipment	Electrical
Outside Lid Tee - Gusset	905	Equipment	Electrical

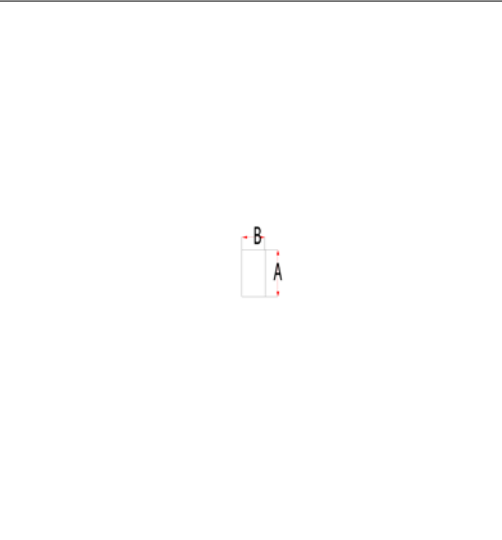

Dims	
A=Width	
B=Depth	
C=Length	
D=Rail Width	
E=Rung Width	
F=Rung Depth	
G=Rung Height	
H=Rung Spacing	
I=Wire Diameter	
J=Wire X Spacing	
K=Wire Y Spacing	

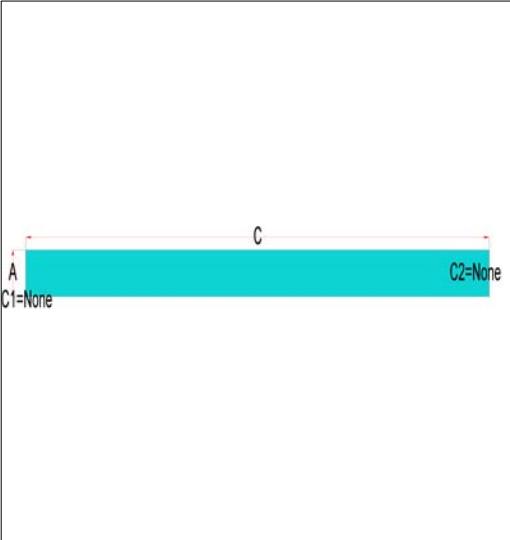
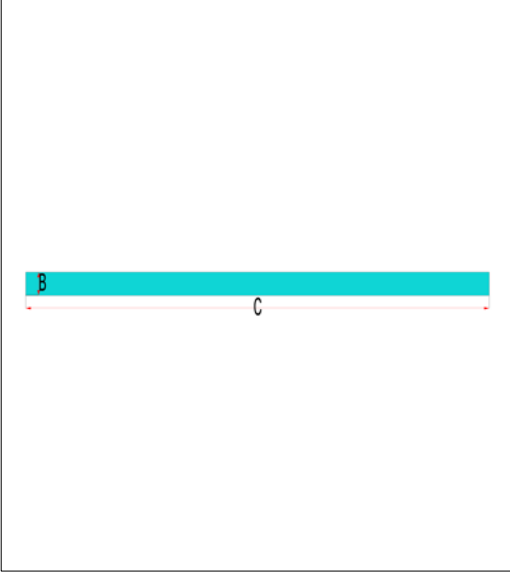

Options	
Type	
Pattern	
X Size	
Y Size	
Base Depth	
Use Spacing	

Conn's	Seams
C1	
C2	

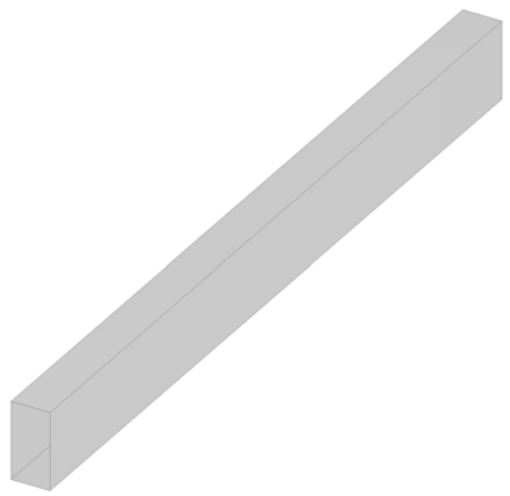



**Dims**

A=Width  
 B=Depth  
 C=Angle  
 D=Inner Radius  
 E=Extension  
 F=Rail Width  
 G=Rung Width  
 H=Rung Depth  
 I=Rung Height  
 J=Rung Inset  
 K=Wire Diameter  
 L=Wire X Spacing  
 M=Wire Y Spacing

**Options**

Rungs  
 Type  
 Throat Type  
 Heel Type  
 Base Depth  
 Use Spacing  
 Double  
 Pattern

**Conn's**

C1  
 C2  
 C3

**Seams**

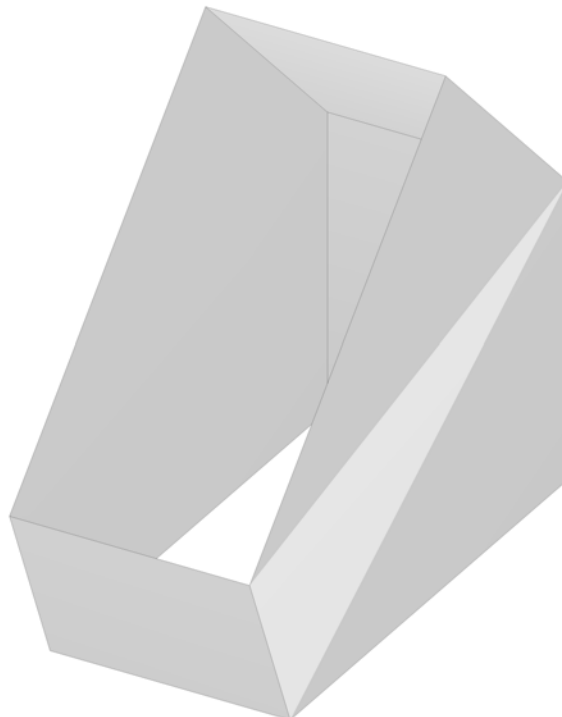



Dims	
A=Width B=Depth C=Angle D=Inner Radius E=Extension F=Rail Width G=Rung Width H=Rung Depth I=Rung Height J=Rung Inset K=Wire Diameter L=Wire X Spacing M=Wire Y Spacing	
Options	
Rungs Type Throat Type Heel Type Base Depth Use Spacing Double Pattern	
Conn's	Seams
C1 C2 C3	

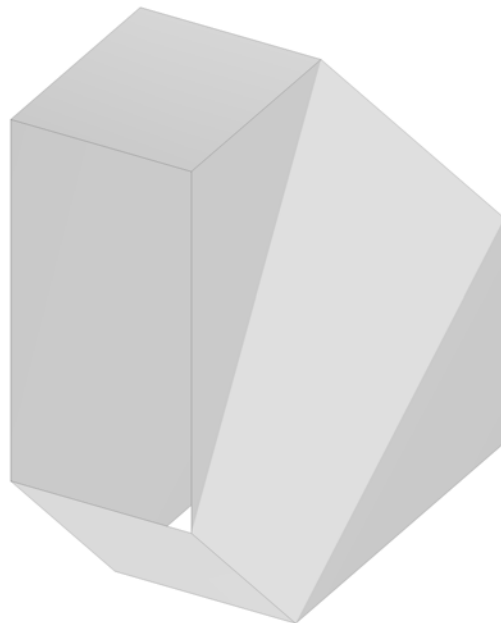

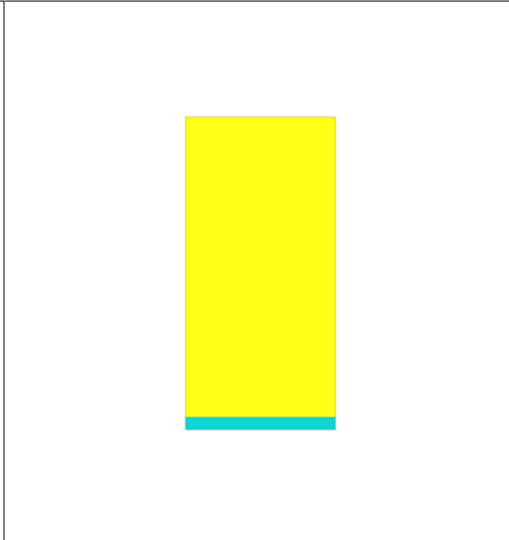

**Dims**

A=Width  
 B=Depth  
 C=Angle  
 D=Inner Radius  
 E=Extension  
 F=Rail Width  
 G=Rung Width  
 H=Rung Depth  
 I=Rung Height  
 J=Rung Inset  
 K=Wire Diameter  
 L=Wire X Spacing  
 M=Wire Y Spacing

**Options**

Rungs  
 Type  
 Throat Type  
 Heel Type  
 Base Depth  
 Use Spacing  
 Double  
 Pattern

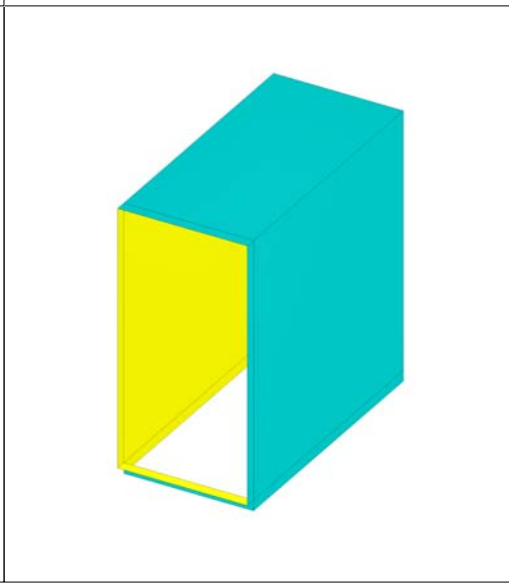
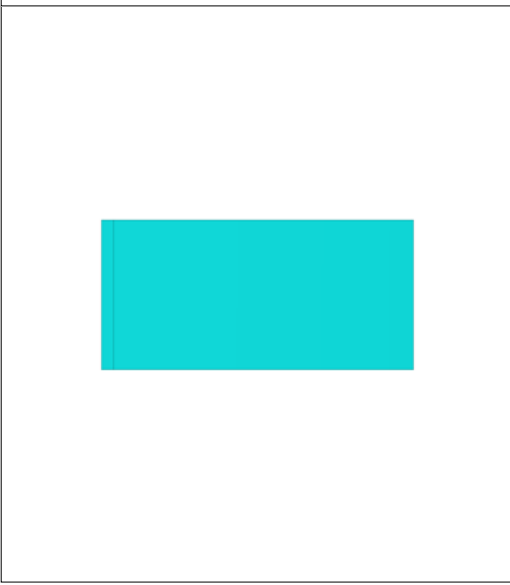

<b>Conn's</b>		<b>Seams</b>	
C1			
C2			
C3			

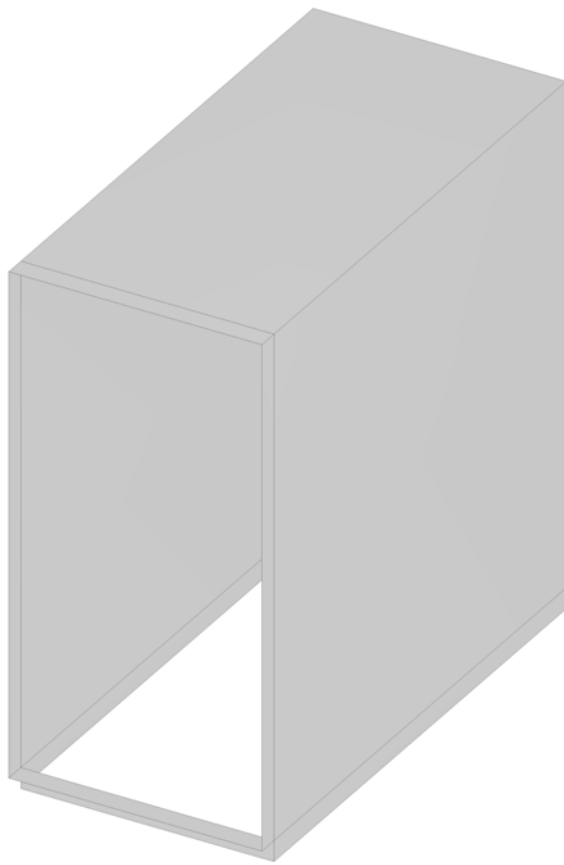

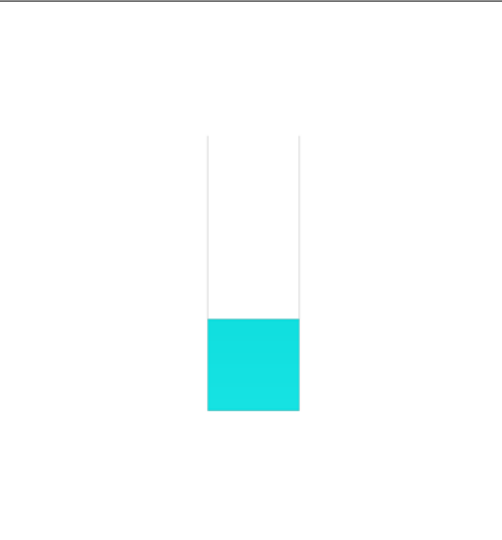

Dims	
A=Width	
B=Depth	
C=Width	
D=Inner Radius	
E=Extension	
F=Rail Width	
G=Rung Width	
H=Rung Depth	
I=Rung Height	
J=Rung Inset	
K=Wire Diameter	
L=Wire X Spacing	
M=Wire Y Spacing	
N=Bottom Extension	

Options	
Type	
Throat Type	
Pattern	
X Size	
Y Size	
Inlet	
Outlet	
Double	

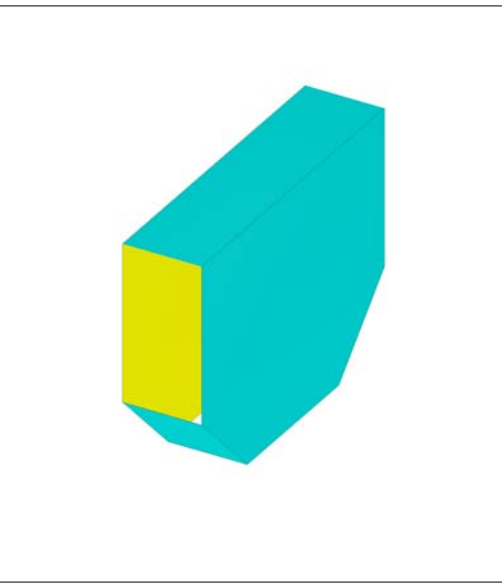
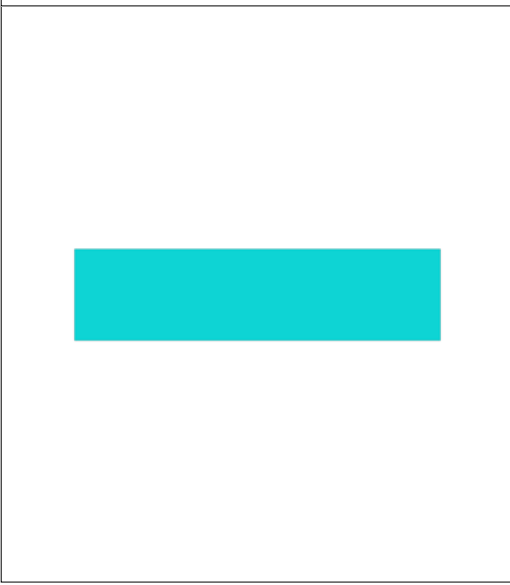

Conn's	Seams
C1	
C2	
C3	

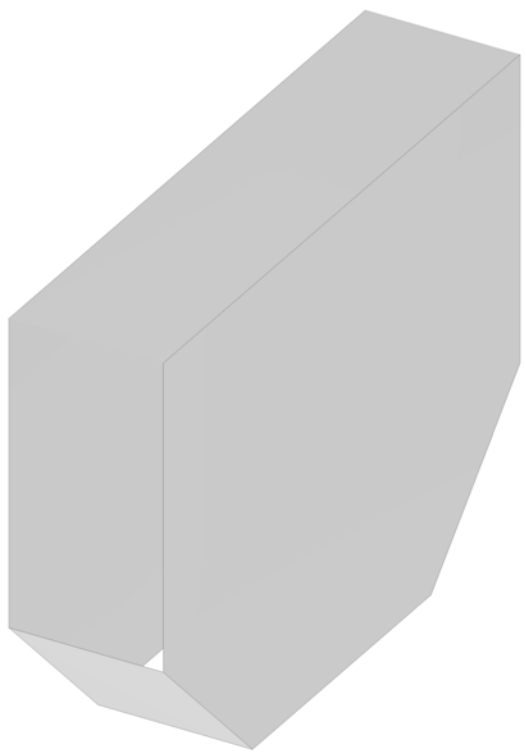

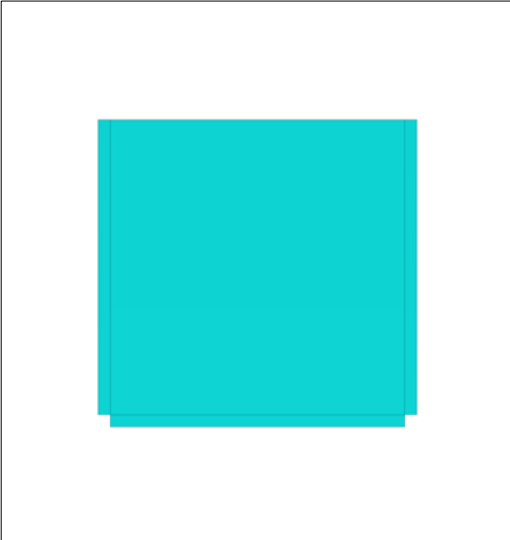

**Dims**

A=Width  
 B=Depth  
 C=Width  
 D=Inner Radius  
 E=Extension  
 F=Rail Width  
 G=Rung Width  
 H=Rung Depth  
 I=Rung Height  
 J=Rung Inset  
 K=Wire Diameter  
 L=Wire X Spacing  
 M=Wire Y Spacing  
 N=Bottom Extension

**Options**

Type  
 Throat Type  
 Pattern  
 X Size  
 Y Size  
 Inlet  
 Outlet  
 Double

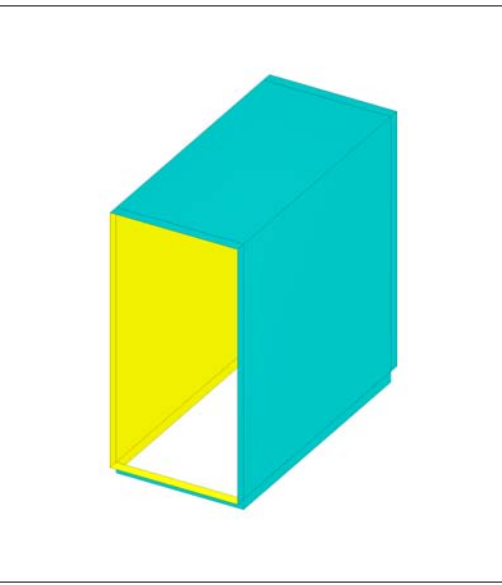
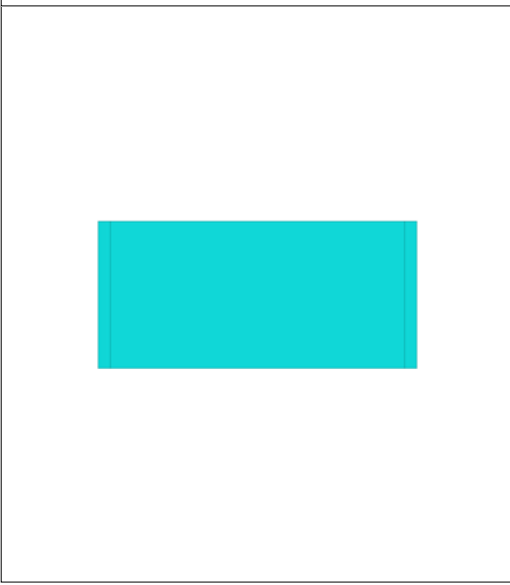

Conn's	Seams
C1	
C2	
C3	

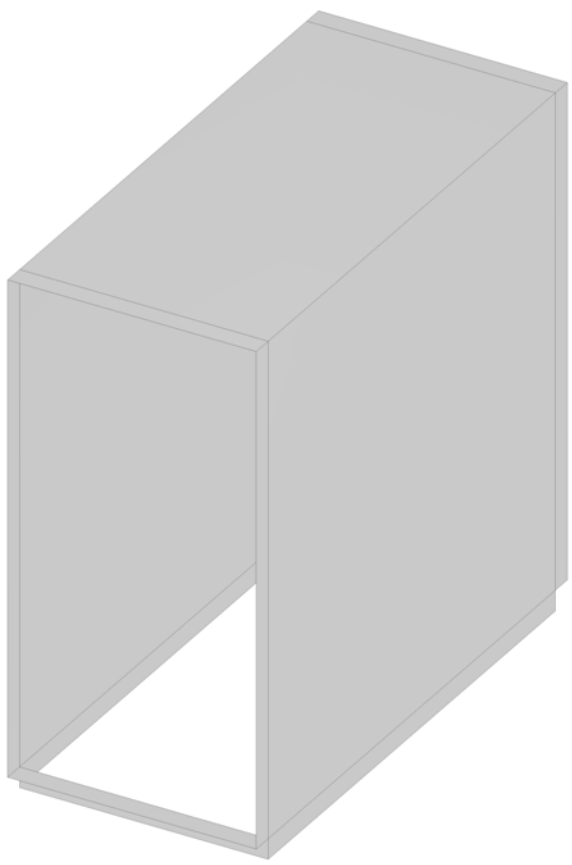

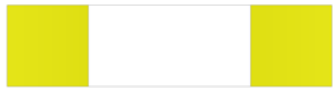
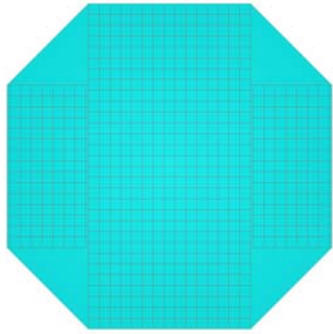

**Dims**

A=Width  
 B=Depth  
 C=Radius  
 D=Extension  
 E=Rail Width  
 F=Rung Width  
 G=Rung Depth  
 H=Rung Height  
 I=Rung Inset  
 J=Wire Diameter  
 K=Wire X Spacing  
 L=Wire Y Spacing

**Options**

Throat Type  
 Type  
 Pattern  
 X Size  
 Y Size

**Conn's**

C1  
 C2  
 C3  
 C4

**Seams**

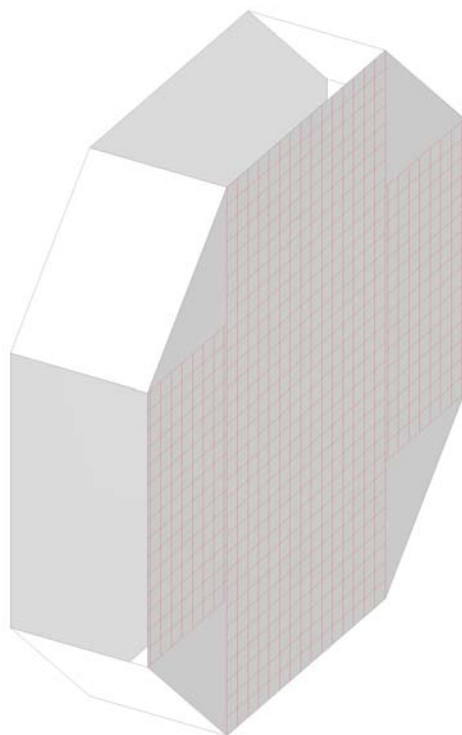

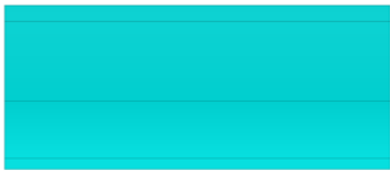
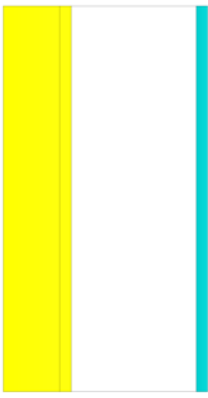
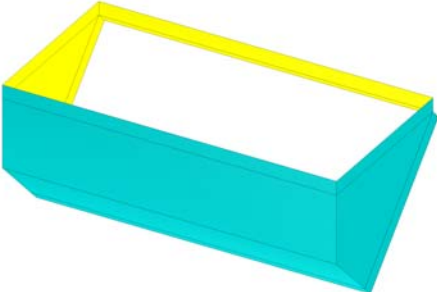
		<p style="text-align: center;">Dims</p> <p>A=Width          B=Depth          C=Angle          D=Nominal Radius          E=Extension          F=Rail Width          G=Rung Width          H=Rung Depth          I=Rung Height          J=Rung Inset</p>	
		<p style="text-align: center;">Options</p> <p>Rungs          Type          Angle</p>	
		<p style="text-align: center;">Conn's</p> <p>C1          C2</p>	<p style="text-align: center;">Seams</p>

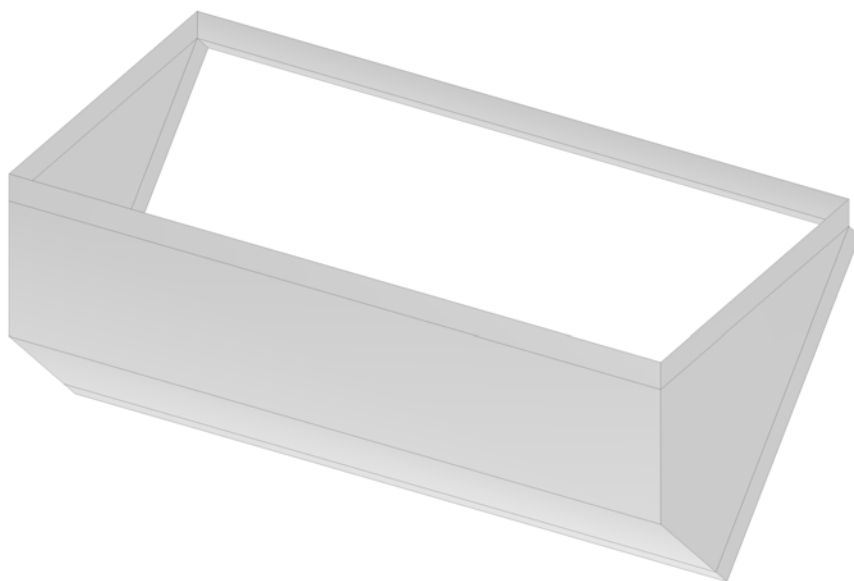

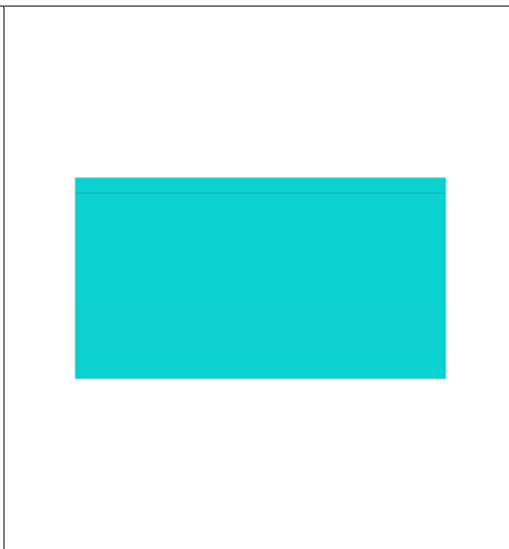
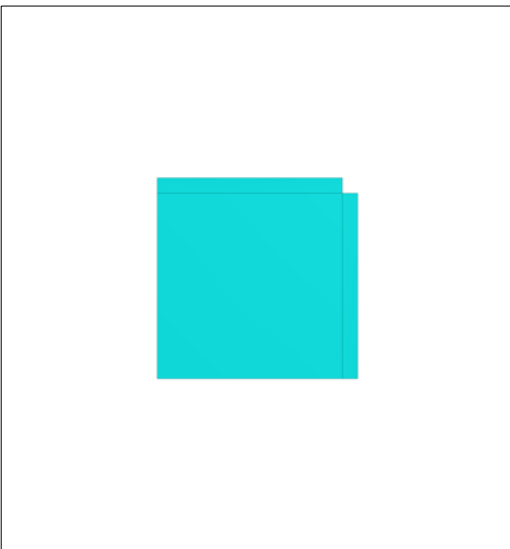

Dims	
A=Width	
B=Depth	
C=Angle	
D=Nominal Radius	
E=Extension	
F=Rail Width	
G=Rung Width	
H=Rung Depth	
I=Rung Height	
J=Rung Inset	

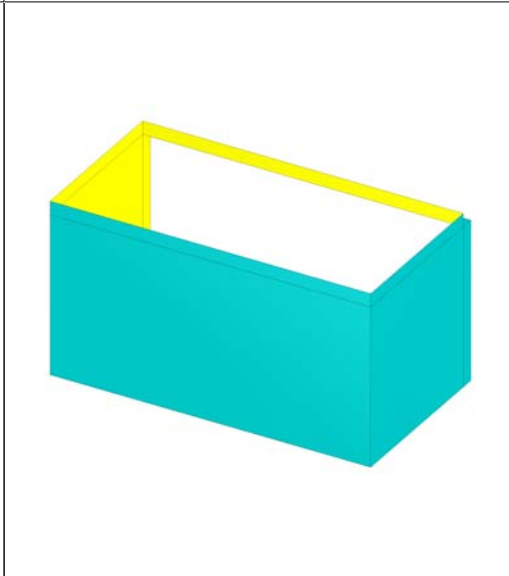
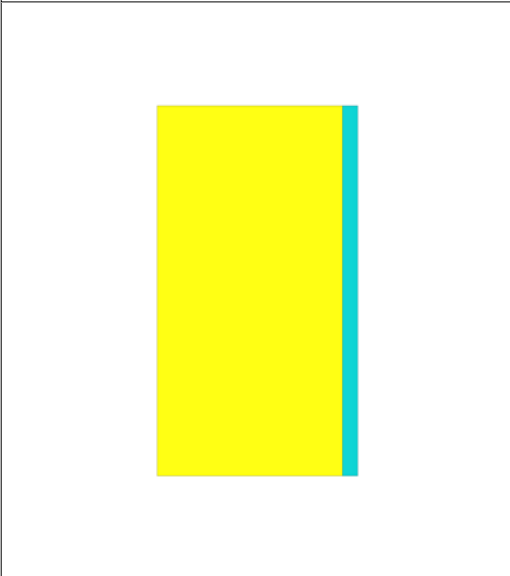

Options	
Rungs	
Type	
Angle	

Conn's	Seams
C1	
C2	

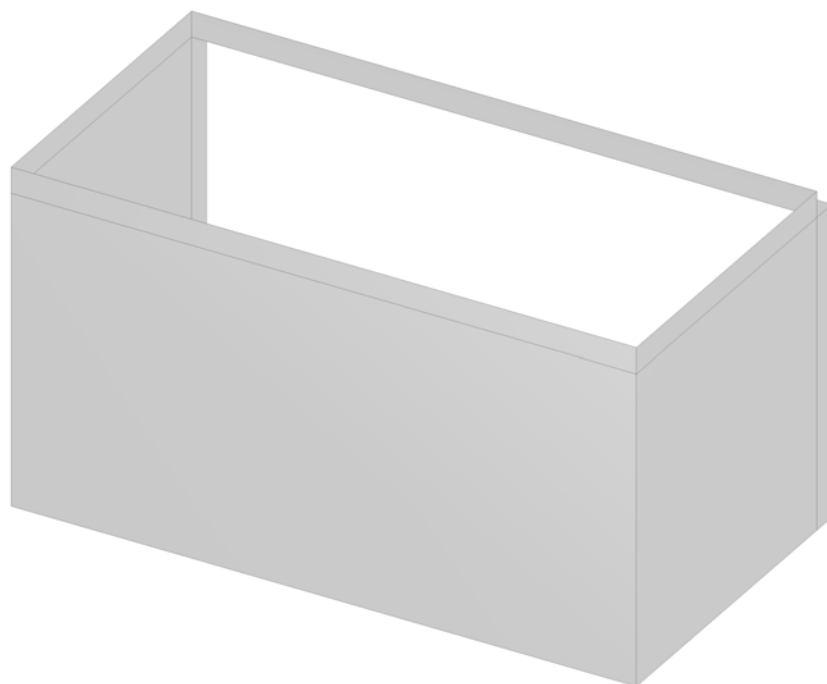

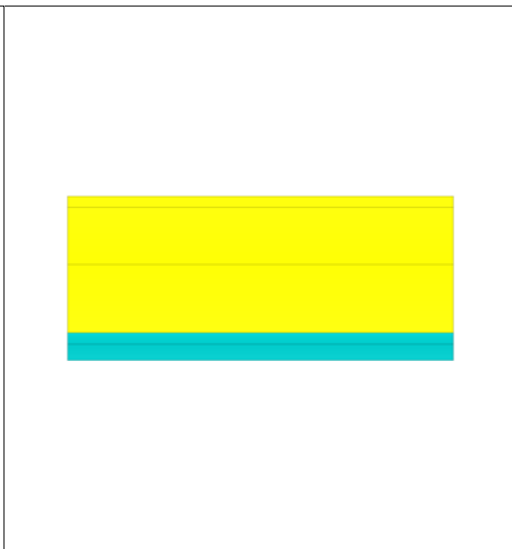

Dims	
A=Width	
B=Depth	
C=Angle	
D=Nominal Radius	
E=Extension	
F=Rail Width	
G=Rung Width	
H=Rung Depth	
I=Rung Height	
J=Rung Inset	

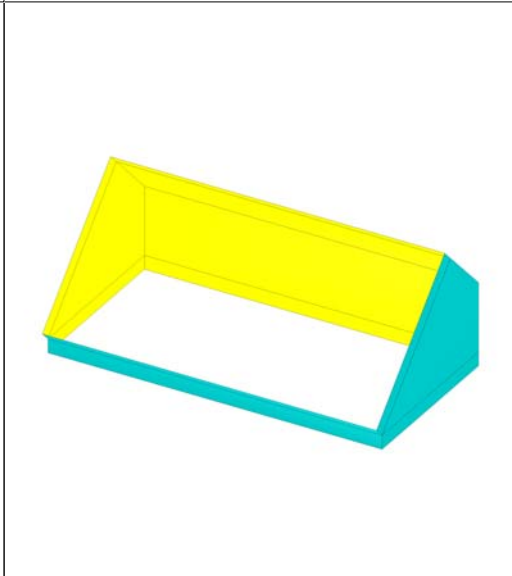
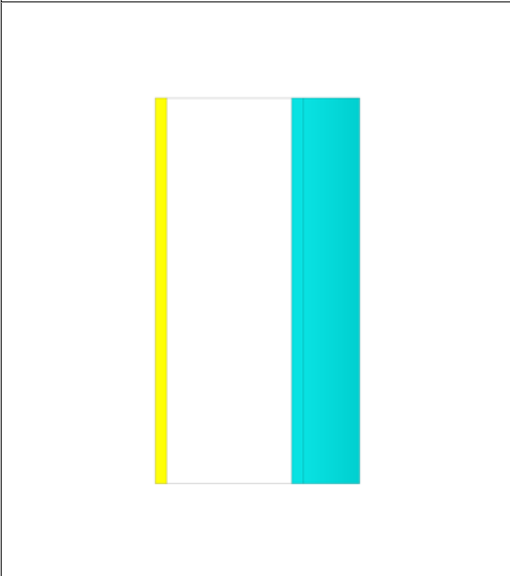

Options	
Rungs	
Type	
Type	
Angle	

Conn's	Seams
C1	
C2	

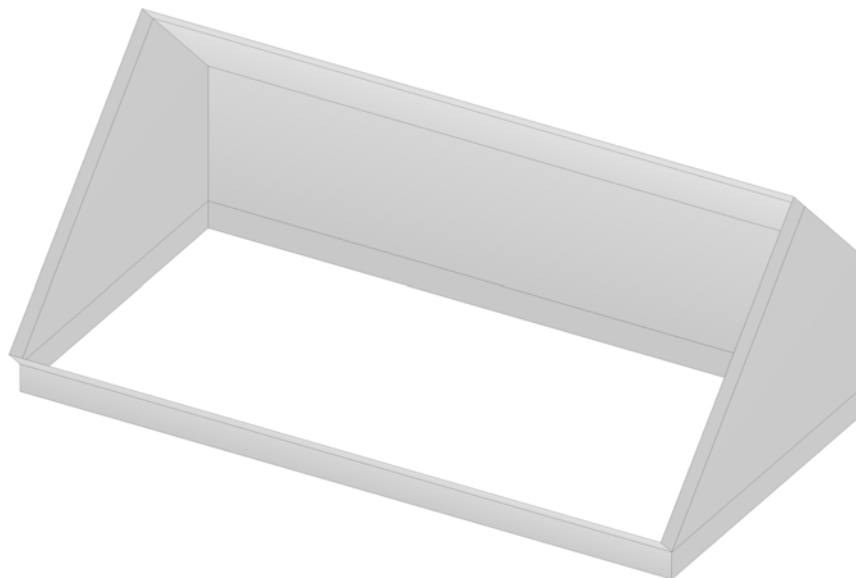

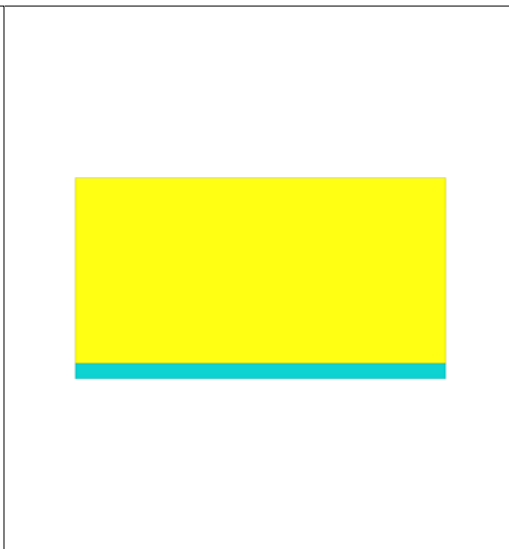
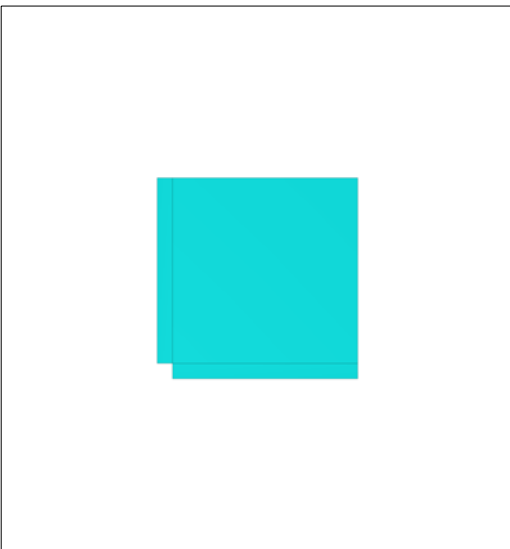

**Dims**

A=Width  
 B=Depth  
 C=Angle  
 D=Nominal Radius  
 E=Extension  
 F=Rail Width  
 G=Rung Width  
 H=Rung Depth  
 I=Rung Height  
 J=Rung Inset

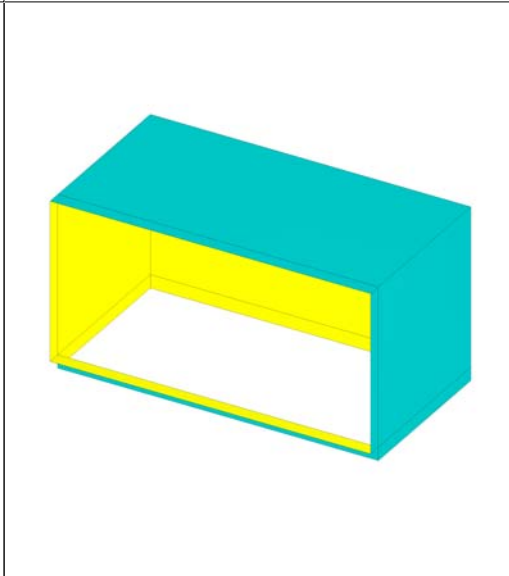
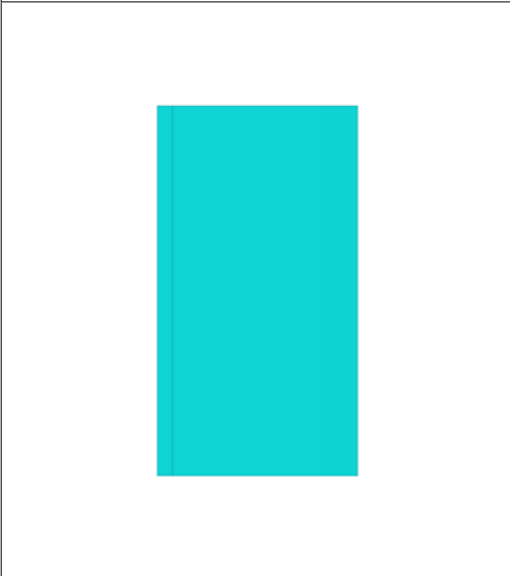

**Options**

Rungs  
 Type  
 Type  
 Angle

**Conn's**

C1  
 C2

**Seams**

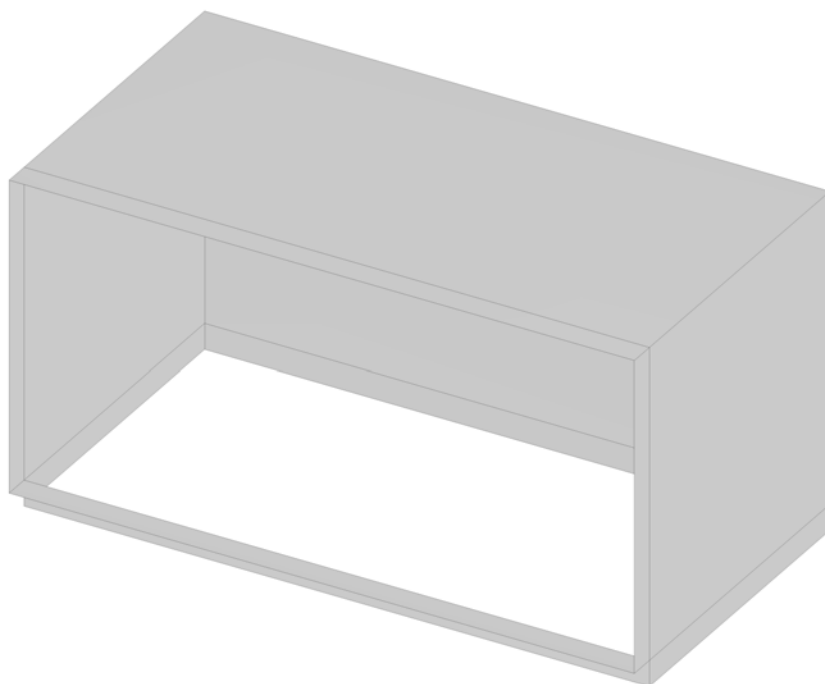

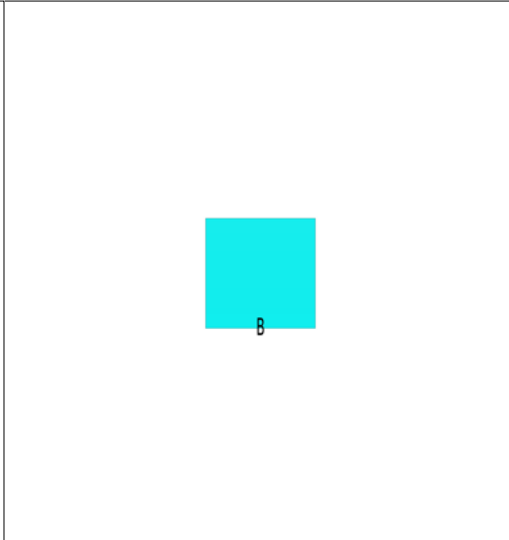
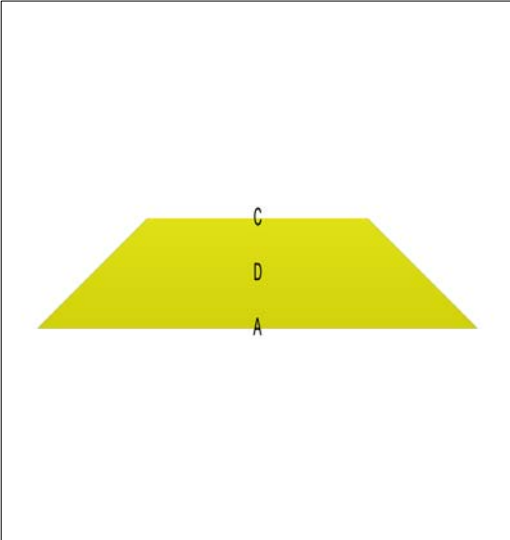

**Dims**

A=Width  
 B=Depth  
 C=Width  
 D=Length  
 E=Rail Width  
 F=Rung Width  
 G=Rung Depth  
 H=Rung Height  
 I=Rung Inset  
 J=Wire Diameter  
 K=Wire X Spacing  
 L=Wire Y Spacing  
 M=Depth

**Options**

Offset  
 Type  
 Angle  
 Pattern  
 X Size  
 Y Size  
 Base Depth  
 Use Spacing

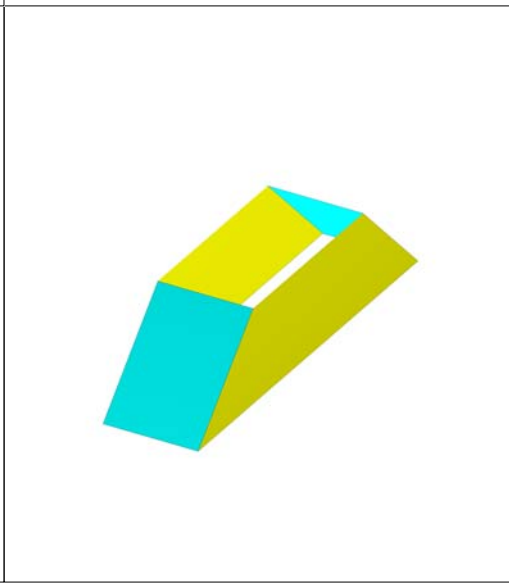
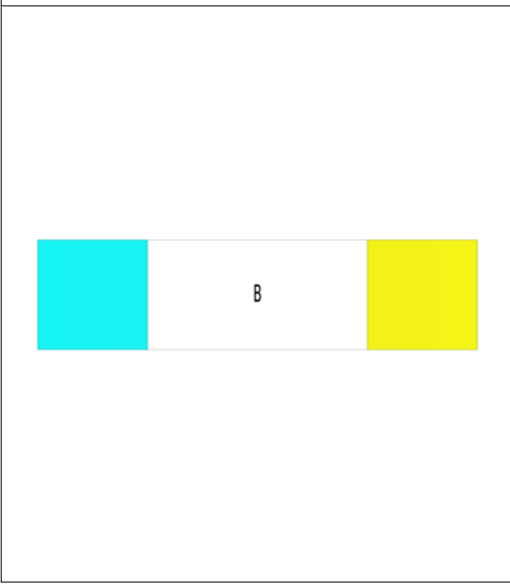

Conn's	Seams
C1	
C2	

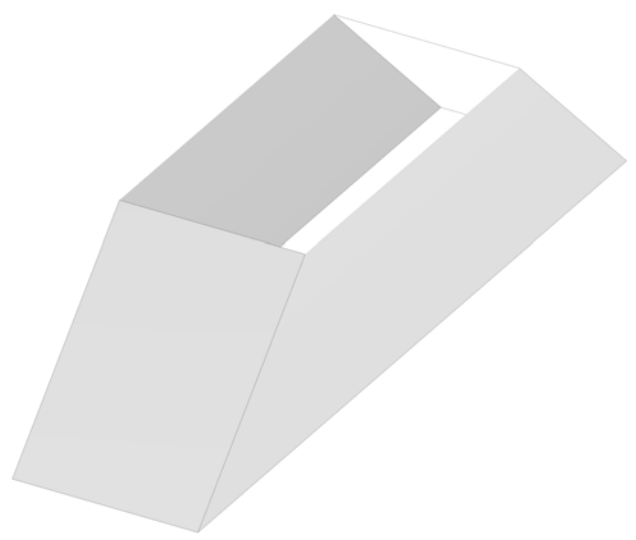

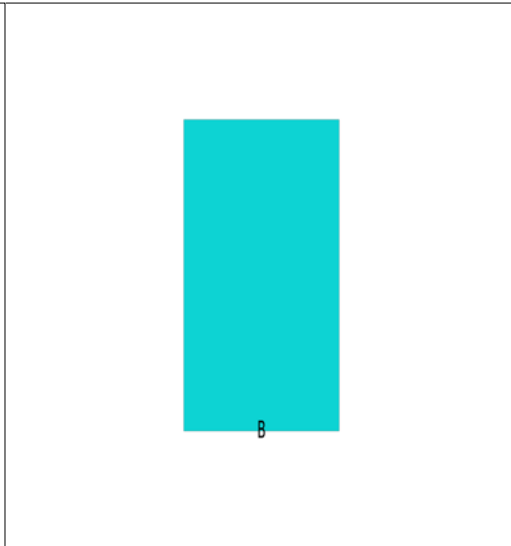
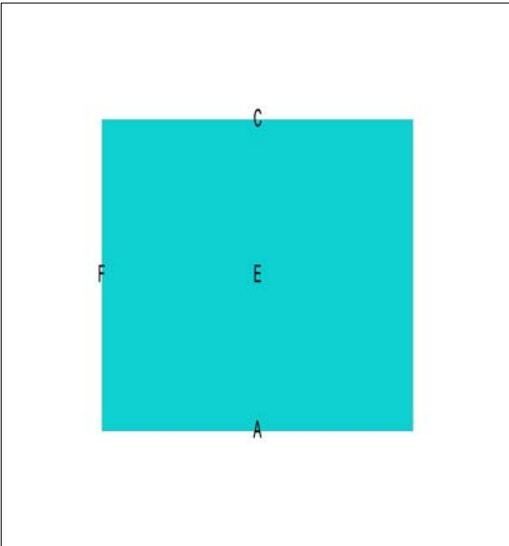

Dims	
A=	Width
B=	Depth
C=	Width
D=	Angle
E=	Length
F=	Extension
G=	Rail Width
H=	Rung Width
I=	Rung Depth
J=	Rung Height
K=	Rung Inset
L=	Wire Diameter
M=	Wire X Spacing
N=	Wire Y Spacing
O=	Depth

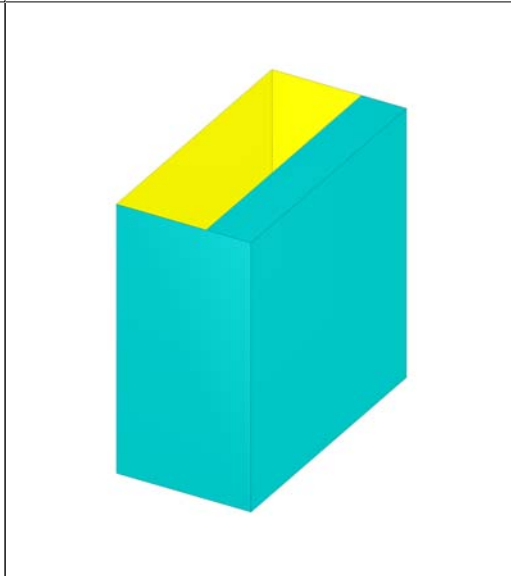
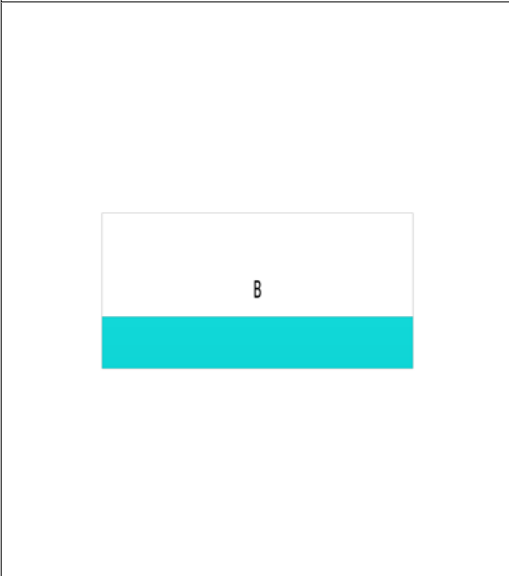

Options	
Offset	
Type	
Angle	
Pattern	
X Size	
Y Size	
Base Depth	
Use Spacing	

Conn's	Seams
C1	
C2	

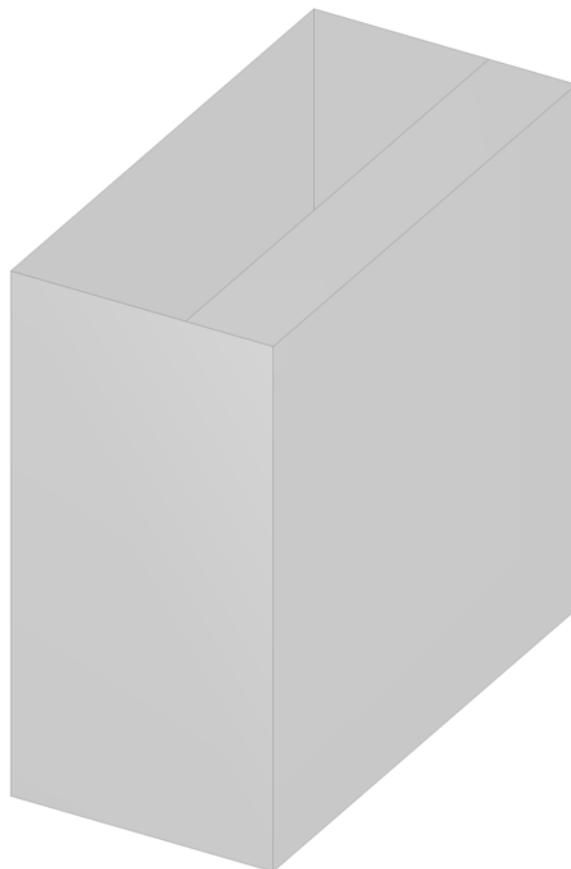

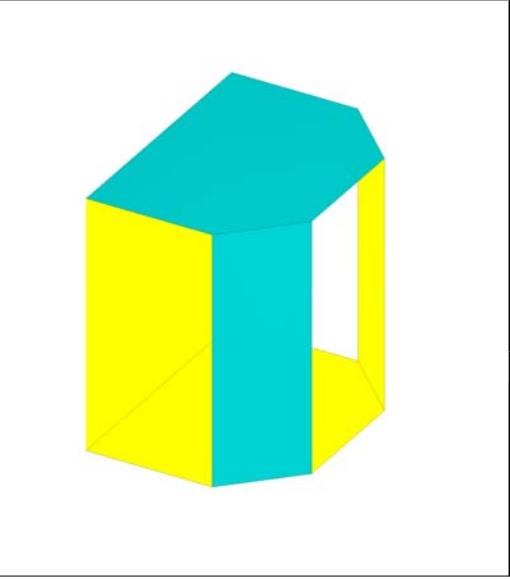
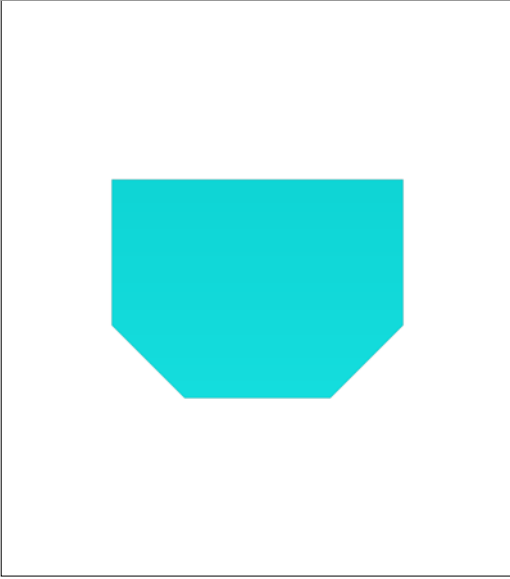
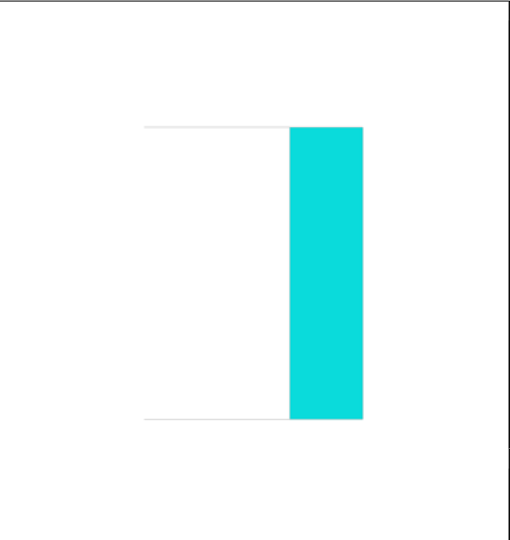
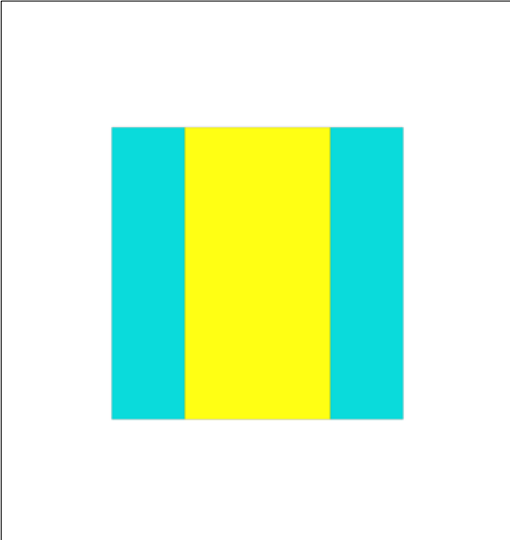

Dims	
A=Width	
B=Depth	
C=Branch Width	
D=Inner Radius	
E=Extension	
F=Rail Width	
G=Rung Width	
H=Rung Depth	
I=Rung Height	
J=Rung Inset	
K=Wire Diameter	
L=Wire X Spacing	
M=Wire Y Spacing	
N=Bottom Extension	

Options	
Type	
Throat Type	
Type	
Pattern	
X Size	
Y Size	
Inlet	
Outlet	
Double	

Conn's	Seams
C1	
C2	
C3	

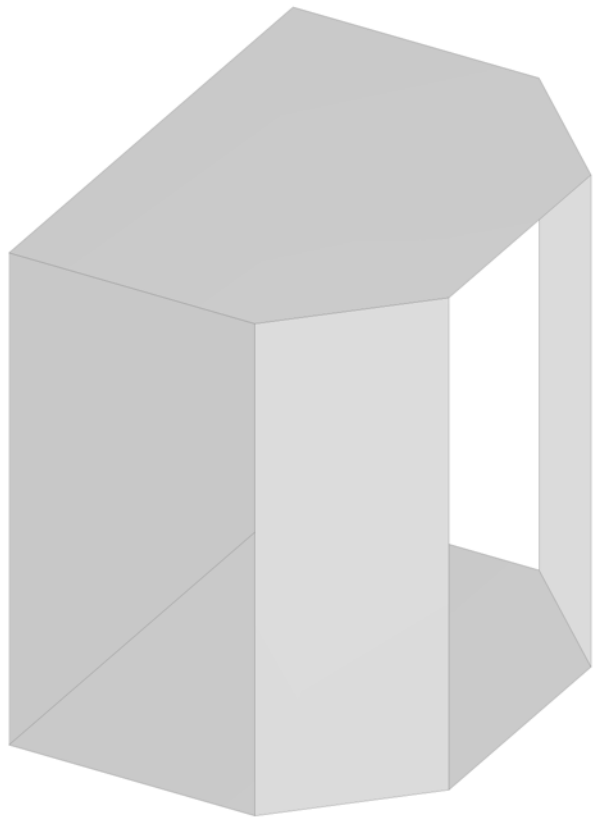

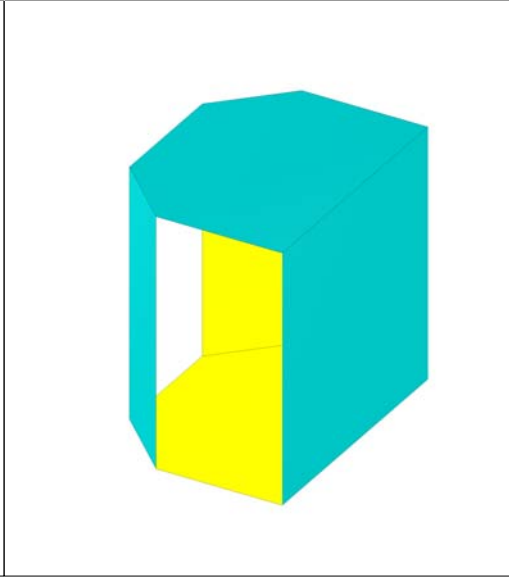
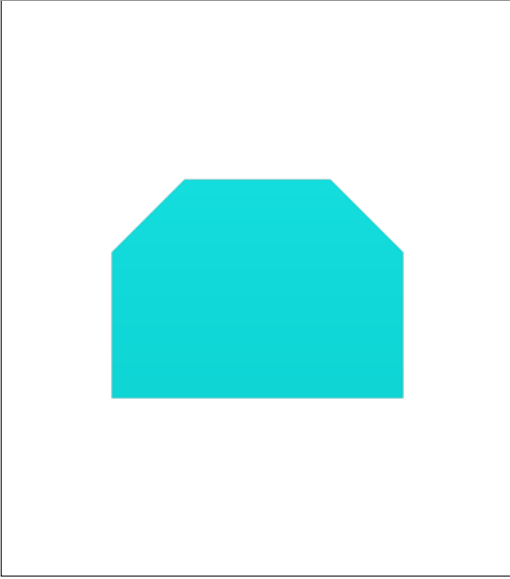
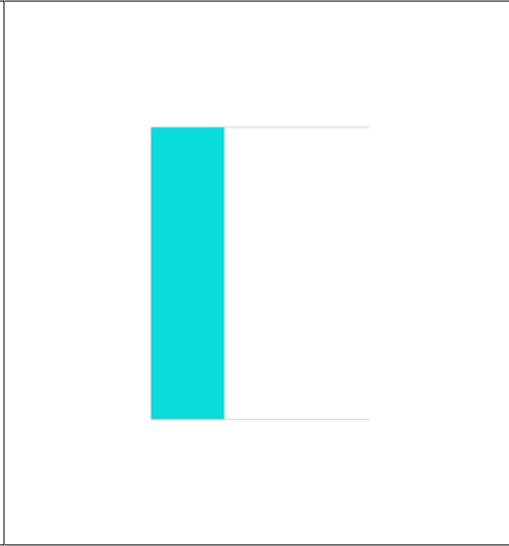
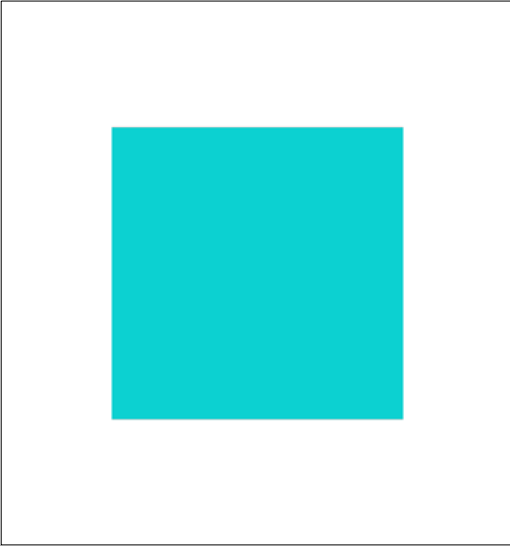

Dims	
A=Width	
B=Depth	
C=Branch Width	
D=Inner Radius	
E=Extension	
F=Rail Width	
G=Rung Width	
H=Rung Depth	
I=Rung Height	
J=Rung Inset	
K=Wire Diameter	
L=Wire X Spacing	
M=Wire Y Spacing	
N=Bottom Extension	

Options	
Type	
Throat Type	
Type	
Pattern	
X Size	
Y Size	
Inlet	
Outlet	
Double	

Conn's	Seams
C1	
C2	
C3	

